

### ENET 180° 2X3 Connector

Ethernet high-speed modular twisted pair data solution,  
0.13mm<sup>2</sup> - 0.35mm<sup>2</sup> wire

#### Part-No:

##### → Plug:

EUN032-BSFXX (0.13mm<sup>2</sup>)

Cable Diameter: 3.2±0.10mm

EUN132-BSFXX (0.35mm<sup>2</sup>)

Cable Diameter: 3.8±0.2mm

ESN032-BSFXX (0.13mm<sup>2</sup>)

Cable Diameter: 4.2±0.2mm

##### → Socket:

ESN032-BSMXP

"X" indicates 1/2/3/4

according to code A/B/C/D

#### Mating design:

→ Secondary Locking by CPA(Optional)

#### Terminal System:

→ 0.4X0.5mm Terminal, Sn plated

→ Wire size 0.13/0.35mm<sup>2</sup>

#### To the specifications:

→ 100 BASE-T1, OPEN Alliance TC2, UTP

→ 1000 BASE-T1, Open Alliance TC9,UTP

→ USCAR 2

#### General:

→ IPXXB(unmated)

→ 360° shielding

→ Coding: A/B/C/D

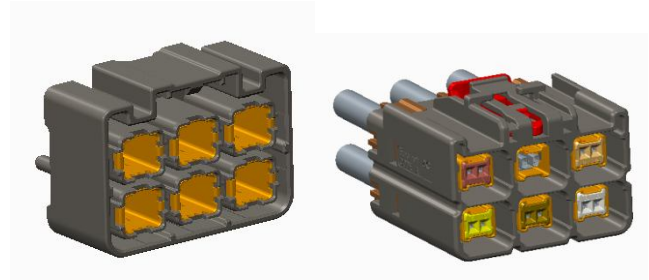

#### Construction:

→ Housing material: PBT-GF15 UL94 V0

→ Terminal material: Copper alloy

→ RFI/EMI protection: Metal shielding

#### Dimensional characteristics:

Socket Side:

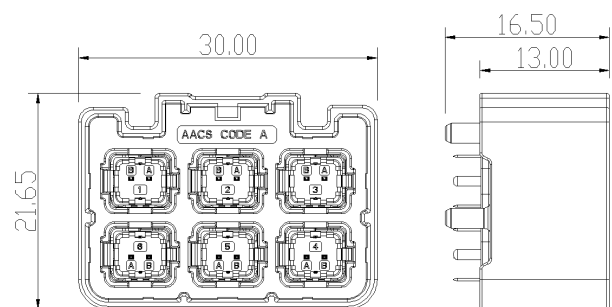

Plug Side:

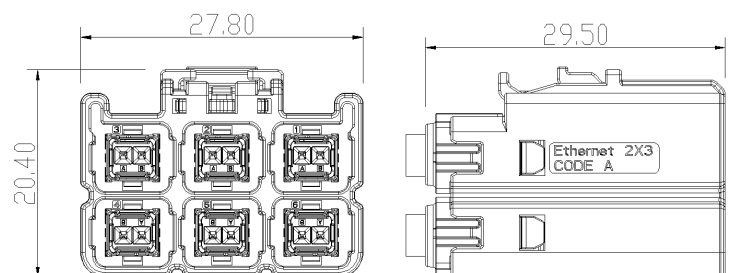

#### Performance characteristics:

→ Pull out force: ≤120N

→ Temperature range: -40°C to +105°C

→ Mating cycles: 30min

→ Working voltage: 100 V rms

→ Power current: ≤ 1.5 A DC